

®

i n v e n t

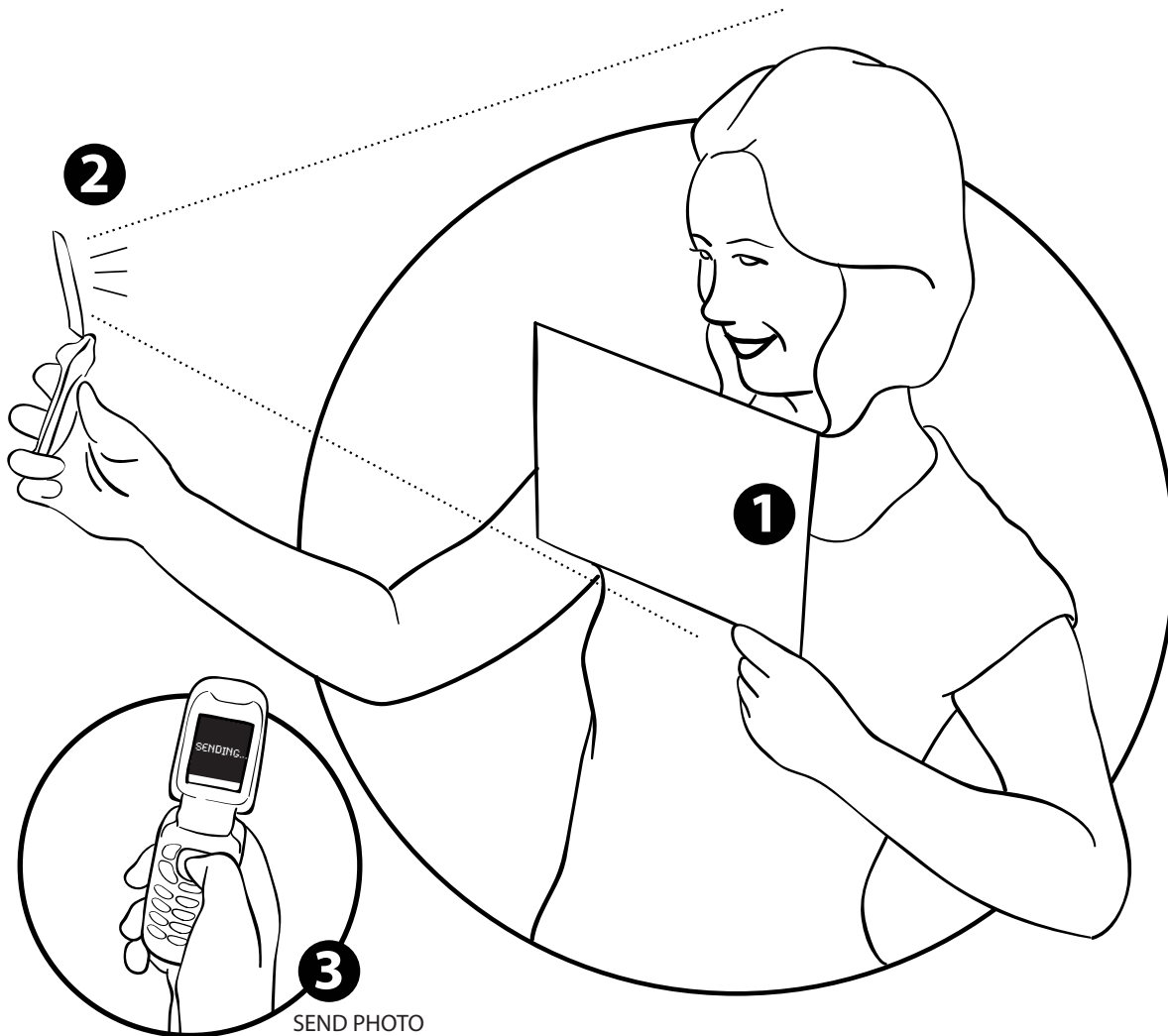

inHand

Foundation color tips at your fingertips

Simply hold up this color chart, snap a photo and receive your customized makeup consultation in seconds.

With inHand, a new imaging and color calibration technology from HP, buying the right foundation every time is a snap. Just hold the color chart under your chin and take your picture, or have a friend take it for you, with a handheld camera. Then send the photo to somewhere@hp.com. Within seconds, you'll receive an e-mail on your camera device that tells you what foundation color best matches your skin tone.

For best readability and results, be sure to:

- Brush your hair back from your face.
- Hold the color chart only at the corner tip.
- Face the camera straight on and hold the chart straight below your chin.
- Fill the camera view with your full face and the full color chart.